

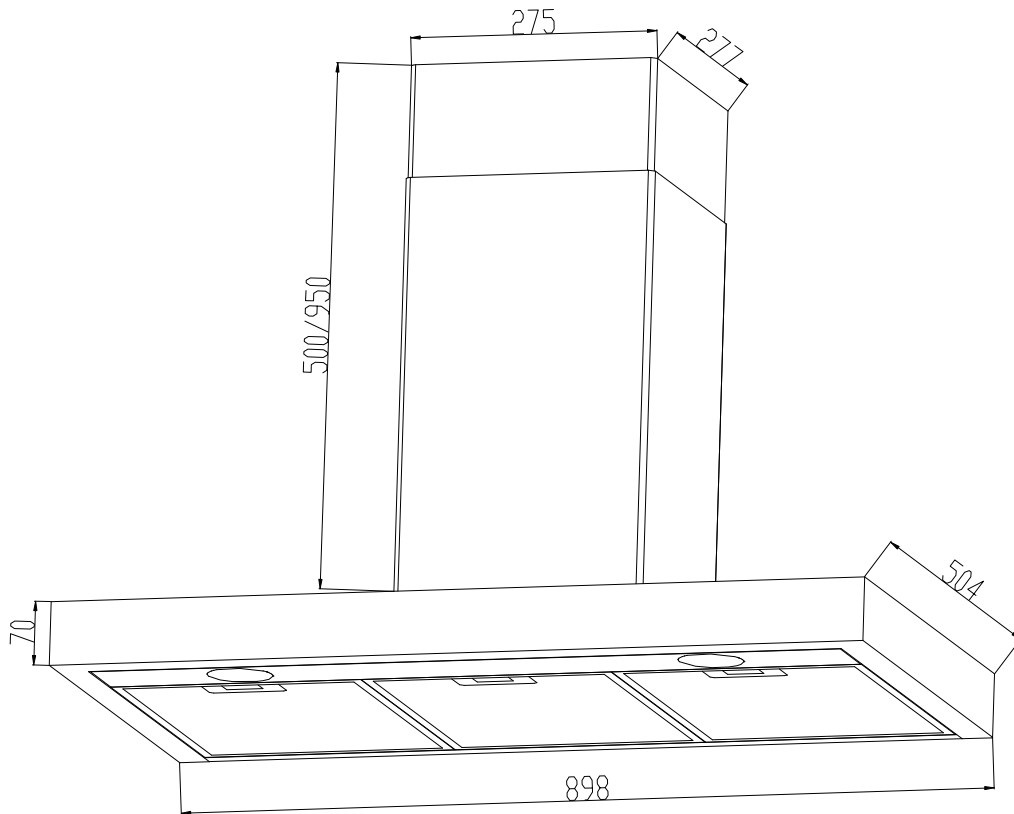

ARISTON

Description: **ARISTON WALL CANOPY**
Model Numbers: **ARCH90BIX**



*Model may vary slightly from images pictured.
All measurements are in mm.*

Overview

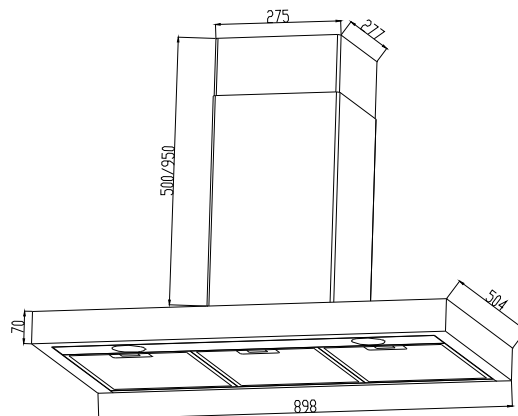

Pre-installation

Thank you for purchasing a quality Ariston range hood. Ariston has a high standard of quality control and every range hood is tested and approved before it leaves the factory.

Important:

In certain circumstances electrical appliances may be a danger hazard.

1. This appliance is not intended for use by persons (including children) with reduced physical, sensory or mental capabilities, or lack of experience or knowledge, unless they have been given supervision or instruction concerning the use of the appliance by a person responsible for their safety. Children should be supervised to insure that they do not play with the appliance.
2. Do not check the status of the filters while the cooker hood is operating.
3. Do not touch the light bulbs after appliance use.
4. Do not disconnect the appliance with wet hands and do not disconnect the power cord with extreme force.
5. Do not flambé underneath range hood.
6. Avoid free flame, as it may cause damage to the filters and be a fire hazard.
7. If frying food, ensure to check regularly to avoid the oil overheating and becoming a fire hazard.
8. Unplug the appliance before carrying out maintenance or replacing lamps.
9. If the power cord is damaged, it must be replaced by the manufacturer, an authorised service centre or similarly qualified persons to avoid a hazard.
10. Indoor use only.
11. When the appliance is not in use and before cleaning, unplug the appliance from the outlet.
12. It is recommended to operate the range hood prior to cooking.
13. It is recommended to leave the range hood in operation for 15 minutes after cooking is terminated in order to completely eliminate cooking vapours and odours.
14. Turn off the range hood when not in use.
15. Don't use the range hood if it is damaged in any way.
16. Caution: Accessible parts may become hot when used with a cooking appliance.
17. Don't immerse the range hood in liquid.
18. The exhaust air must not be discharged into a flue which is used for exhausting fumes from appliance burning gas or other fuels (not applicable to appliances that only discharge the air back into the room).
19. Regulations concerning the discharge of air have to be fulfilled. There shall be adequate ventilation of the room when the range hood is used at the same time as appliances burning gas or other fuels.
20. Clean the surface of the cooker hood regularly using cloth moistened with denatured alcohol or non-abrasive liquid detergent.
21. There is a fire risk if cleaning is not carried out in accordance with the instruction.
22. The 600mm units are intended for use above hobs with four elements and the 900mm units are intended for use above hobs units with five elements.
23. If the instruction for the minimum distance between the supporting surface of the cooking vessels on the hob and the lowest part of the range hood are specified by hob instructions, these instructions should be taken into account.
24. Warning: Failure to install the screws or fixing devices in accordance with the instructions may result in an electrical hazard.

Pre-Installation - *continued*

Typical equipment required:

- electric drill, screwdriver, tape measure, spirit level
- duct tape, jig saw, ladder (*if ducting*)
- Torch (*If natural lighting is insufficient*)

Contents of packaging:

1x Range hood
1x Φ 150mm round ducting
7x Wall Plugs
7x Long Wall Screws
3x Chimney Screws – Pointed End, 12mm in length
2x Chimney Bracket Screw – Flat End
2x Chimney (top & bottom)
2x Mounting Brackets, (1x Wall Mount, 1x Chimney Mount)

Appliance Details:

Voltage & Frequency: 220-240V 50Hz

Lamp max: 2x2W DC12V

Rated Input Power: 274W

Ducting Options

The method of ducting should be carefully considered before installing the range hood. The guide below recommends the ducting components to use for all common ducting configurations - through the top of the home (for the roof and soffit) and through the rear of the home. 150mm round ducting should be used in conjunction with this model range hood. Alternatively this range hood can be operated in recirculation mode (see Recirculation mode).

The highlighted area in the table below gives the recommended Uniduct item numbers for different mounting and outlet options.

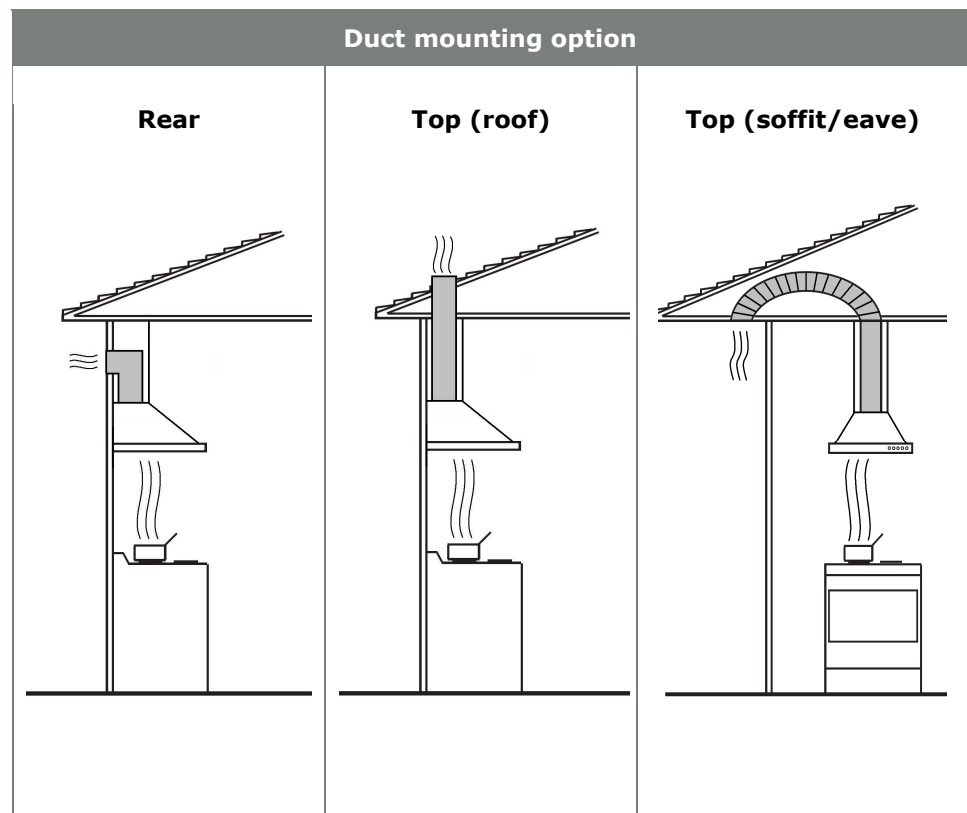

Extra lengths and/or bends may be required, depending on the length required and whether there is any structural material in the run e.g. rafters. Please note that this chart is designed as a guide.

Installation

Installation Recommendations

- Please read this instruction manual before installing and using this range hood. Keep this instruction manual in a safe place for future reference.
- This range hood can be used either in the Ducted Mode (ducting fumes to the outside) or in the Recirculation Mode (internal recycling). The choice of modes can be left to customers.
- Only a qualified and trained service technician can undertake the work of installation and servicing. At least two people will be required to mount the range hood.
- Check that the mains voltage corresponds to the one indicated on the rating plate fixed inside the range hood.
- Check that the domestic power supply guarantees adequate earthing.
- Do not connect the range hood to exhaust ducts carrying combustion fumes (boilers, fireplaces, etc.).
- If the range hood is used in conjunction with non-electrical appliances (e.g. gas burning appliances), a sufficient degree of aeration must be guaranteed in the room in order to prevent the backflow of exhaust gas. The kitchen must have an opening directly with the open air in order to guarantee the entry of clean air to the room.
- The minimum distance between the supporting surface of the cooking surface for the cooking vessels of the hob and the lowest part of the range hood must be 650mm. If the installation instructions for gas hobs specify a greater distance, this must be taken into account.
- On stainless steel hoods, carefully remove the plastic protective film from all exterior surfaces of the hood and chimney prior to final installation.
- The manufacturer will not be held liable for any damages resulting from incorrect or improper installation.

Installation position

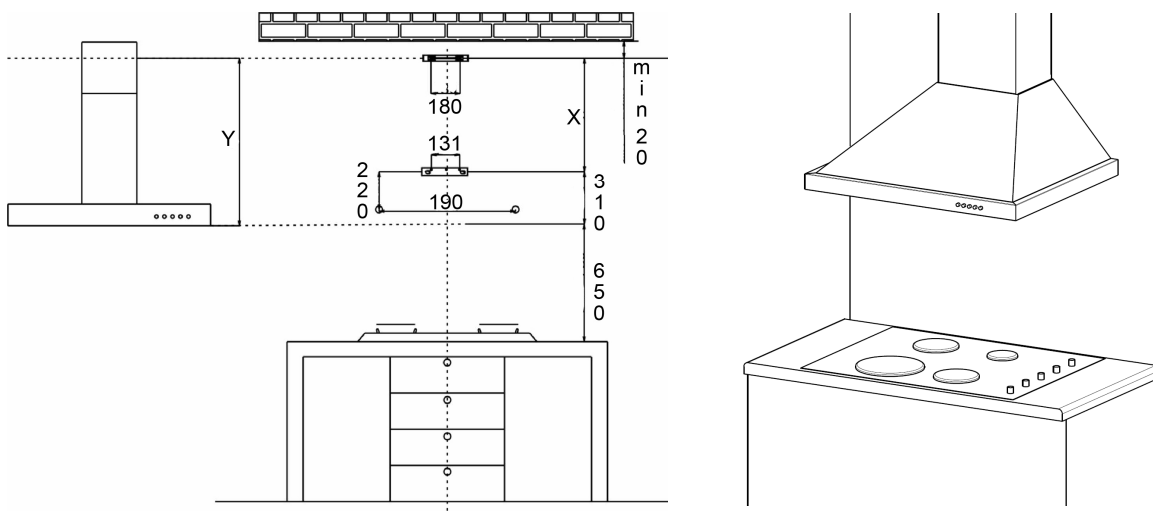

1. Draw a vertical line on the supporting wall up to the ceiling, or as high as practical, at the centre of the area in which the range hood will be installed.
2. Draw a horizontal line at 650mm above the hob.
3. Place flue cover mounting bracket on the wall as shown about 20mm from the ceiling or upper limit, aligning the centre (notch) with the vertical reference line.
4. Mark the wall at the centre of the holes in the bracket.
5. Place the range hood mounting bracket 6.2 on the wall central to the vertical reference line, with the hooks aligned upwards.
6. Mark the wall at the centre of the three holes in the bracket.
7. Mark two holes on the wall as shown 220mm below the range hood mounting bracket holes for fixing the range hood body.
8. Drill $\phi 10$ mm holes at the seven centre points marked and fit the wall plugs.
9. Fix the two brackets using the long wall screws.

Installation - *continued*

Mounting the Hood Body

Mounting to a stud is recommended. However, if fitted to other wall linings (plasterboard, concrete etc) suitable fixings will be required. Before drilling any holes check that the wall and ceiling are clear of any electrical cables, pipes etc.

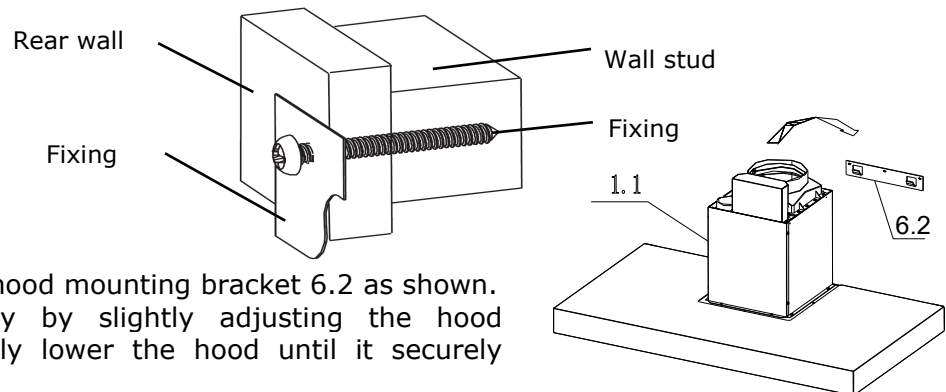

1. Hook the body onto the hood mounting bracket 6.2 as shown.
2. Balance the hood body by slightly adjusting the hood mounting bracket. Gently lower the hood until it securely engages the bracket.
3. Remove the filters and fix the range hood body to the wall using two long wall screws.

Damper (Flaps) Fitting

1. Ensure plastic wrapping is removed from flaps.
2. Fix the flaps into the air outlet adapter.
3. Check that the flaps are locked correctly in the air outlet adapter. The flaps should open and close freely.

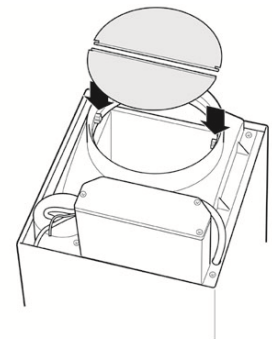

Depending on the preferred installation/ducting mode, follow step **Recirculating mode or Ducted mode**.

Recirculating Mode

Caution: To reduce the risk of fire, use flexible metal ductwork only.

1. Attach an adequate length of $\phi 150\text{mm}$ round duct into the recessed area of the air outlet adapter.
2. Secure the duct to the air outlet using duct tape.
3. Install the charcoal filters (after fitting chimney).

Please note that the air will flow out from the two vents on the sides of the chimney top.

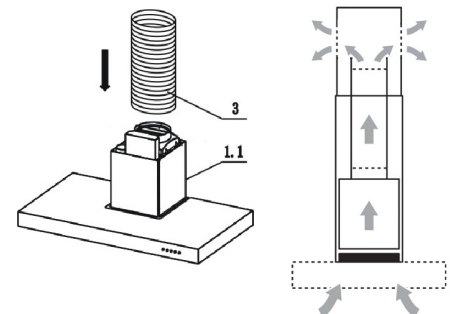

Ducted Mode

Caution: To reduce the risk of fire, use flexible metal ductwork only.

1. Decide where the ductwork will run between the hood and the outside.
2. A straight, short duct run will allow the hood to perform most efficiently.
3. Long duct runs, elbows, and transitions will reduce the performance of the hood. Use as few of them as possible. Larger ducting may be required for best performance with longer duct runs.
4. Attach an adequate length of $\phi 150\text{mm}$ round duct to the air outlet adapter. Secure in place with duct tape.
5. The air must not be discharge into a flue that is used for exhausting fumes from appliances burning gas or other fuels" "Regulations concerning the discharge of air have to be fulfilled.
6. Install a roof/wall cap. Connect round metal ductwork to cap and work back towards hood location. Use duct tape to seal the joints between ductwork sections.

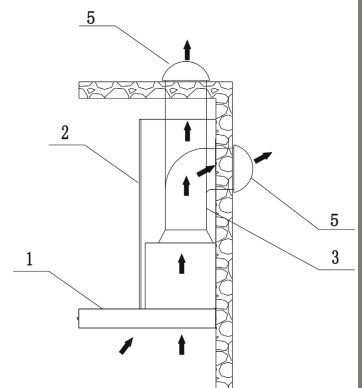

Installation - *continued*

Chimney Assembly

1. Place the chimney bottom onto the range hood body around the outlet (bent edge down).
2. Fix the chimney bottom to the range hood body with the three 12mm screws (from inside the range hood body).
3. Place the chimney top inside the chimney bottom (vents to the top).
4. Lift the chimney top to the chimney mounting bracket, position the slots over the mounting bracket holes and attach together using the two 10mm chimney bracket screws.

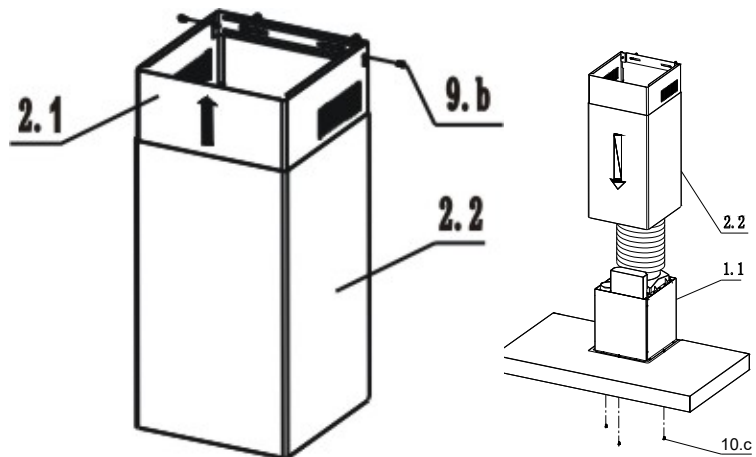

Operating Instructions

Controls

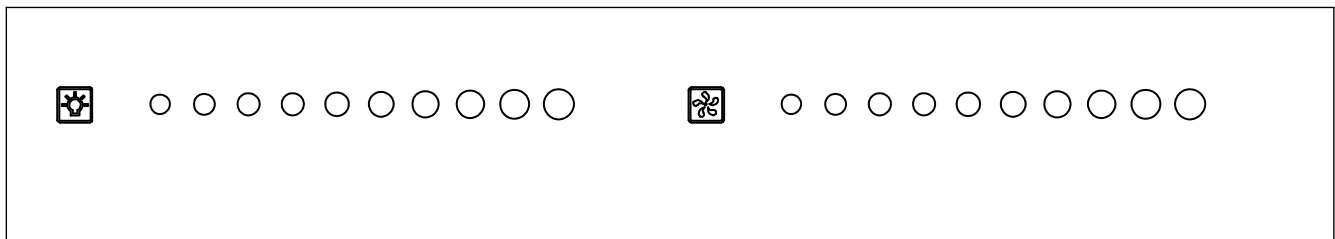

Control Panel

The range hood is operated using the touch panel at the front of the appliance.

The light controls are to the left of the control panel. The light button turns the lamps on and off. The light intensity is controlled by touching any of the round icons to the right of the light button (from dim to bright). There are 10 intensity settings.

The fan speed controls are to the right of the control panel. The fan button turns the fan on and off. The fan speed is controlled by touching any of the round icons to the right of the fan button (from slowest to fastest). There are 10 speed settings.

Cleaning and Maintenance

General Maintenance

Switch off the canopy before cleaning or maintenance. To prevent surface damage never use abrasive or oil based liquid cleaners. To clean the surfaces of the appliance, use mild detergent and warm water. In areas of high humidity and coastal environments cleaning should be carried out frequently.

Warning: a build-up of oil may occur if the wall canopy is not cleaned regularly.

Filter Maintenance

To maintain efficiency, the filters should be removed regularly (approximately monthly), and washed using hot soapy water or the dishwasher. **Note - some discolouration of the frame may occur if washed in the dishwasher.**

Range hoods fitted with charcoal filters are designed to remove grease and odours from cooking vapours prior to the cleansed air re-entering the kitchen (when the range hood is in recirculation mode). Charcoal filters should be replaced every two to four months depending on use.

Note: Fully saturated charcoal filters can become a barrier to air movement therefore limiting range hood performance. In the event of fire, grease laden filters could be flammable and therefore regular replacement is recommended. In ducted installations, conventional aluminium filters are recommended.

Product approvals and ratings

Product rating	274W Max at 240V 50Hz
Electric approval AS/NZS	60335.2.31:2013
EMC AS/NZS	CISPR14:2001
Performance tested	IEC61591

Trouble Shooting

FAULT	POSSIBLE CAUSE	SOLUTION
Light on, but motor does not work	Fan switch turned off	Select a fan switch position
	Fan switch failed	Contact Ariston Service
	Motor failed	Contact Ariston Service
Light and motor do not work	House fuses blown	Reset/ Replace fuses
	Power cord loose or disconnected	Refit cord to power outlet. Switch power on
Lights not working	Broken/ Faulty globes	Replace globes (Contact Ariston Service)
Insufficient suction	The distance between the range hood and the gas top is too far	Refit the range hood to the correct distance
The range hood inclines	The fixing screw is not tight enough	Tighten the hanging screw and make it horizontal

NOTE: Any electrical repairs to this appliance must conform to your local, state and federal laws. Please contact the service centre if in any doubt before undertaking any of the above. Always disconnect the unit from the power source when opening the unit.